

◆ MACHINE UNIT

SPECIFICATIONS		SERIES NO	DW-35, DW-35AC	DW-45, DW-45AC
Work-Tank size (WxD)	mm		960x580	1,100x670
Work table size (XxY)	mm		690x430	800x550
X x Y axes travel	mm		450x350	550x450
Z axis travel (by AC Motor)	mm		400 (Optional heightening)	400 (Optional heightening)
U x V axes travel (under 50mm H)	mm		30x30	30x30
Max. work-piece thickness	mm		400	400
Max. work-piece size (WxDxH)	mm		450x350x400	550x450x400
Max. work-piece weight	kgs		350	400
The wire bobbin travel	mm		230	230
Dia. of molybdenum wire	mm		ø0.18-0.2 (Standard ø0.18)	ø0.18-0.2 (Standard ø0.18)
Maximum taper Angle	Degree		6 degree(±3°) under 50mm High	6 degree(±3°) under 50mm High
External dimensions (WxDxH)	mm		1,260x1,833x1,982	1,360x1,840x2,200
Packing dimensions (WxDxH)	mm		1,850x1,970x2,200	1,870x2,080x2,250
Net weight	kgs		1,700	1,850

◆ DIELECTRIC FLUID UNIT

Capacity of dielectric fluid	ℓ	120	120
Dielectric fluid tank size (WxDxH)	mm	900x500x280	900x500x280

◆ POWER SUPPLY UNIT

Machining Average Current	A	5	5
Cutting speed	mm ² /min	100~200	100~200
Cutting accuracy	mm	±0.015	±0.015
Best finish roughness	μm RA	1.0	1.0
Max. power consumption	KVA	3.0	3.0
External dimensions (WxDxH)	mm	950x610x1,700	950x610x1,700
Packing dimensions (WxDxH)	mm	1020x970x2,090	1020x970x2,090
Net weight	kgs	200	200

◆ FLOOR LAYOUT

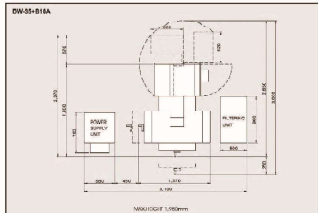

DW-35

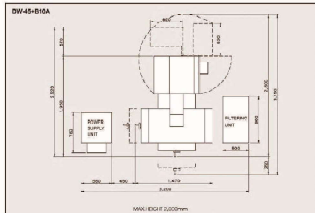

DW-45

◆ STANDARD ACCESSORIES

1. Work lamp. 1 pc
2. Clampers & kits. 1 set
3. Positioning jig set. 1 set
4. Tools & toolbox. 1 set
5. Electrode molybdenum 1 roll wires (φ 0.18mm) 2KM.
6. Dielectric liquid. 20 ℓ
7. Operation manual & data. 1 set
8. 2 axes digital readout & linear scales (for model DW-35 & DW-45).
9. U,V Axes ± 3° taper device. (6° under 50mm height)

LIEN SHENG MECHANICAL & ELECTRICAL CO., LTD.

No. 225, Jen Hwa Road, Ta-Li Dist., 41278
 Taichung City, TAIWAN, R.O.C.
 TEL: 886-4-2491-9588 · FAX: 886-4-2491-5275.
 URL: www.aristech.com.tw
 E-mail: sales@aristech.com.tw

DW-V8-1412-2000



ARISTECH®

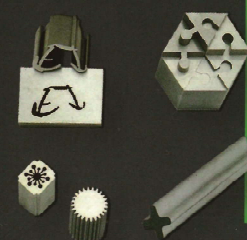

NEW CNC WIRE-CUT E.D.M.
 MOLYBDENUM WIRES

◆ **FEATURES**

- A** The First Set FAST Molybdenum Wire Cut EDM Made in TAIWAN. It is Suitable Super-Hard Alloy, Simple, Complicated Shape Mold & Precision Die. Especial for Economize the Power & Materials.
- B** X,Y Axes adopt Precision Class Ball Screw & Linear Guides. And Linear Scales (Optional) Feed Back Stepping Motors (or AC Servo Motors.)System for The Table movement & Accuracy positioning.
- C** Equipped Automatic Wire Tighten Roller Device for Good Performance When wire cutting. And Multiple Flushing Nozzlers for Good Dielectric Fluid Circulation.
- D** The Highly Rigid, Fine-Grained Cast Iron Machine base. Column, Table, And Mechanite Cast Iron Components Provide the Stability & Long Service Life.
- E** Using Industrial PC. Programming & Edit, The ON-LINE Edit, NC Code Edit, 3B Code Edit, (CAM Graphic Transfer.) Easy to Understand & Operation.
- F** The "AC Motor" Type With AC Servo Motors and Gap Interpolation Function for Whole travel in X,Y Axes. The Remote Controller with Three Different Jog Speed for Position of Mold Adjustment, Wire Alignment, Refer point, Start point Searching, Hold point Return. With 99 Coordinate Number Can be Selection, More Functions & Convenient for Operation.
- G** New Controller & Constant Speed Fine Finish Control System in The "AC Motor" Type, Equipped Cutting Data Bank for Various Material Cutting, Such as : Steel, Stainless Steel, Harden Alloy, Copper, Aluminum . Easy to Understand & Operation. With The Wire Cutting Speed Monitor System, Can be Auto Regulating The Power feed speed & Currents, And Stop Heavy Power & Machining Automatically When Wire Interruption, Saving Times for Irregular Mold Cutting.

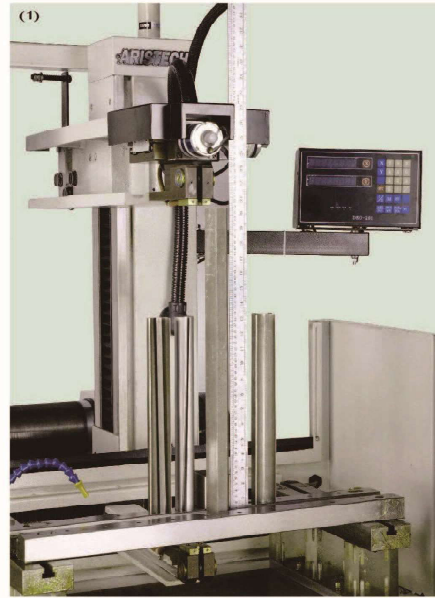

SIMPLE & ACCURACY.
STANDARD MAXIMUM HIGH OF WORK-PIECE. 400mm.
OPTIONAL : 600mm MAXIMUM.

◆ **CNC FUNCTION**

1. Automatic positioning
2. Program editing
 - (a) On-line edit (simple CAD)
 - (b) N.C. code edit (G.M code)
 - (c) 3B code edit
 - (d) DXF edit (CAM, graphic transfer file)
3. Forward or reverse orbital function
4. Automatic or block stop machining
5. Mirror image function
6. Coordinate rotation function
7. Dry run function
8. Battery backup for memory
9. (MDI) manual data input
10. Start point or hold point return
11. Short-circuit interrupt protection & Auto. stop
12. Edming gap compensation
13. Wire diameter compensation
14. Cutting path compensation
15. Cutting path display



EFFICIENT FAST WIRE CUTTING
THE WIRE BOBBIN DRIVING SYSTEM

◆ **CNC CONTROL UNIT**

Circuit system	Power MOS Transistor
Average output current	5A
Voltage select	Automatic Switching.
Off time select	Automatic Switching.
Data input	USB, LAN.
Positioning Display	15" LCD 1F1
Cutting Data Display	5" LCD
Graphic Function	2D/3D Display
Control system	Open Loop/Stepping System Close loop / AC servo system
Control axis.	X,Y,U,V. (4 axes)
Minimum moving unit.	0.001mm
Minimum Setting unit.	0.001mm
Max. command value	±999,999mm
Command system	Abs. / Inc.
Total AC power input	3.0/4.0 KVA

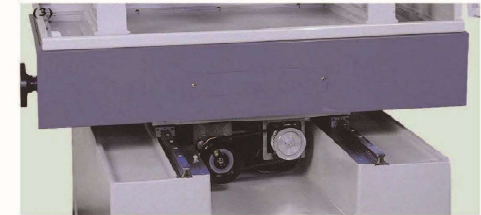

ACCURATE POSITIONING
POSITIONING JIG AND WORK TABLE WITH LINEAR
GUIDES ON SLIDEWAYS

DW-35/DW-45



DW-35AC /DW-45AC

